

Save A Watt Edge[™] Operation Manual

Thank you for purchasing the P4170 Save A Watt Edge[®]. This operating manual will provide an overview of the product, safety instructions, a quick guide to operation, and complete instructions for correct usage. Take the time to completely review these instructions as well as safety warnings to ensure your best use of the product.

The devices that are essential to modern life are numerous, so who can keep track of what has been left on or turned off? This can cause an unwanted surprise when you receive your inflated electricity bill. Make sure the devices that are costing you the most are always in, "real" off mode with the Save A Watt Edge[®].

The Save A Watt Edge[®] is an easy to use timer that is equipped with a tethered motion sensor to detect when there is activity in the room. Whatever device is plugged into the timer will cut off vampire or standard power when not in use after a time delay of your choice, as selected on the side of the timer. The Save A Watt Edge[®] is perfect for, plugging in power strips so that almost an entire room may be shut down during the long periods of time that you are not in the area. The unit can be used in two different modes: Standby Kill Mode and Power Kill Mode.

Definitions:

Standby Mode: Many modern appliances typically have two modes of operation: On and Standby. There is no mode where the appliance is complete "Off" and drawing no power. Typically, standby mode is required so that the appliance can respond to remote controls or keep a portion of their circuitry powered for timers or other purposes. Sometimes referred to as "vampire" power, standby power – over time – can consume significant electricity and contribute to higher bills. Intelligently managing this standby power can lead to financial and environmental savings.

Safety Instructions:

The operating voltage is limited to +/- 10% of Line voltage 120Vac. Do not use it in other voltage rating.

The maximum output current is 10A.

To reduce the risk of electric shock, do not remove cover. No user-serviceable parts inside. Refer servicing to qualified service personnel.

Warning:

! To reduce the risk of fire or electric shock, do not expose this appliance to rain or moisture.

Feature Locations:

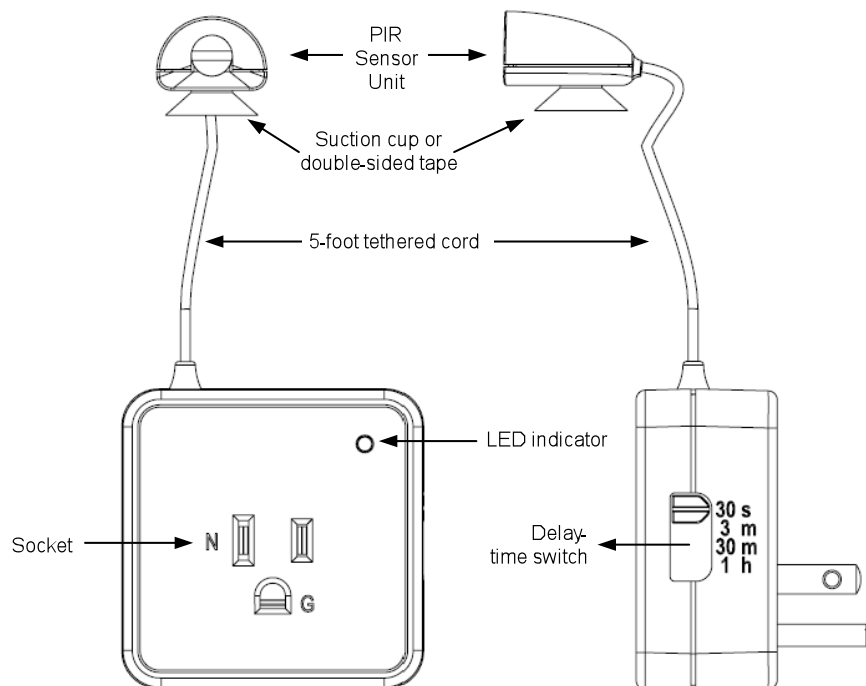

When you install the unit you need to choose if you want to save power by “killing” Standby or Standard Power. You can choose to reduce the “vampire” standby power – that is the power that is consumed by the appliance when it is not in active use. Or, you can reduce standard power wasted when the appliance is left on and nobody is in the room.

For example, when using the Save A Watt Edge® with a Television, if you choose the Standby Kill Mode, the Save A Watt Edge®, will cut the power to your television when you have switched the TV “Off” (into standby mode) and nobody is in the room (after the delay-time has passed). If the TV is left on, the unit will not act.

If you choose Power Kill Mode, the unit will cut the power to your television when it is left on, and no motion has been detected in the room for the set delay-time.

Choose the mode which best matches your appliance and your lifestyle. Follow only one set of instructions below for installation based upon your choice.

Standby Kill Mode:

1. Turn off the appliance before connection to the unit and remove the power cord from the outlet.
2. Plug the appliance’s power cord into the Save A Watt Edge® unit socket, and then connect the Save A Watt Edge® into the outlet. **Connect only one appliance to the unit when using Standby Kill Mode for best results.**
3. After connection be sure to turn on the connected appliance to **standby** mode within 10 seconds.
4. The Save A Watt Edge® will measure the appliance’s standby power; the LED will flash green once per second, which indicates standby power is being measured. After 30 to 40 seconds, the standby power measuring is complete, the LED will illuminate in green. The unit is now in PIR human motion detect mode.
5. Set the delay time switch on the right side of the unit. It can be set to 30 seconds, 3 minutes, 30 minutes, or 1 hour. The shorter the delay-time setting, the more energy will be saved. However, the connected appliance could be turned on and off more often. Choose a setting appropriate for your conditions.
6. If no motion is detected in the covered area, and the appliance is in standby mode, the Save A Watt Edge® will cut power to the appliance according to the delay-time switch setting. For example, the switch is set to 30 minutes, after 30 minutes, the Save A Watt Edge® will cut power, the LED will flash green every 3 seconds. When somebody moves into the covered area, the Save A Watt Edge® will turn power on to the socket and connected appliance at once. The LED will illuminate in green.

Power Kill Mode:

1. Turn off the appliance before connection to the unit and remove the power cord from the outlet.
2. Plug the Save A Watt Edge® into the outlet.
3. **Do not plug the appliance’s power cord into the unit yet.** The Save A Watt Edge® will be set to Power Kill Mode within 10 seconds; the LED will flash green once per second, which indicate the process. After 30 to 40 seconds, the LED shall illuminate green. The unit is now in PIR human motion detect mode.
4. Plug the appliance’s power cord into the Save A Watt Edge® unit socket.
5. If there are many appliances, please use a power strip, plug all appliances’ power cords into the power strip’s outlets and plug the power strip into the Save A Watt Edge® socket.
6. Set the delay time switch on the right side of the unit. It can be set to 30 seconds, 3 minutes, 30 minutes, or 1 hour. The shorter the delay-time setting, the more energy will be saved. However, the connected appliance could be turned on and off more often. Choose a setting appropriate for your conditions.
7. If no motion is detected in the covered area, the Save A Watt Edge® will cut power to the appliance according to the delay-time switch setting. For example, the switch is set to 30 minutes, after 30 minutes, the Save A Watt Edge® will cut power, the LED will flash green every 3 seconds. When somebody moves into the covered area, the Save A Watt Edge® will turn power on to the socket and connected appliance(s) at once. The LED will illuminate in green.

Power Interruption:

If your household suffers a blackout or other power interruption, it may be necessary to reset the Save A Watt Edge® according to the above instructions. Typically this isn’t necessary if you are using the Standby Kill Mode with one connected appliance.

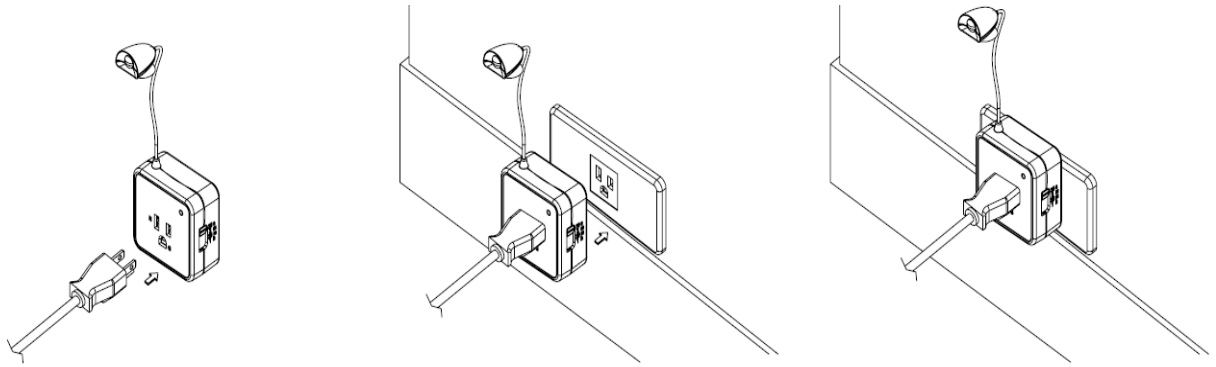

PIR sensor:

The Passive Infrared (PIR) motion sensor is housed in the small housing as depicted above. Be careful to place this sensor so that it has a clear view of the detection area. If the sensor is blocked by walls or other obstructions it may affect proper operation. Use the included suction cup or user-supplied double-sided tape to install the sensor.

Distances: 15 feet (max.), horizontal angle: 40 degree (max.), vertical angle: 70 degree (max.).

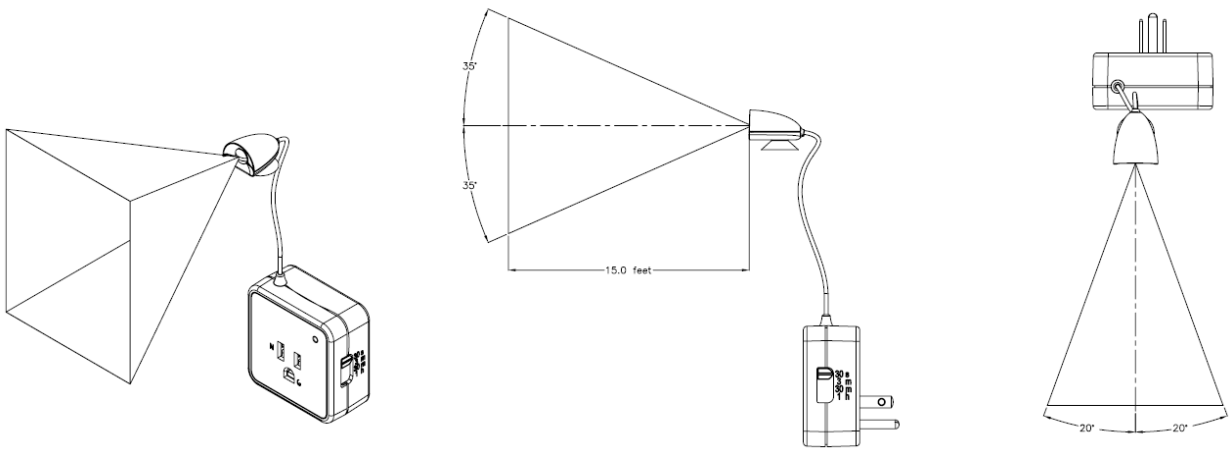

Over Current mode:

When the current load presented by the connected appliance exceeds the maximum current rating, the unit will switch to Over Current mode. The power will be switched off to the outlet

Specification:

| Item | Specification | | Accuracy | | Response Time | |
|--------------------------|--|-------------------------------|----------|-----|---------------|----------------------|
| | Range | Res. | Typ | Max | Action | Recovery |
| Voltage | 120V ± 10% | | --- | --- | --- | --- |
| Current | 10A (max) | | | | | |
| Active Power | 1320 W (max) | | | | | |
| OCP | 13A 15A | | --- | 10% | --- | 3 minute 1 minute |
| Outlet | 1 | | --- | --- | --- | --- |
| Output status LED | Output ON : Green Output OFF : none | | --- | --- | --- | --- |
| Standby Off Power | Level Set | Standby Power * 20% | --- | --- | --- | --- |
| | Delay Time | 30 sec, 3 min, 30 min, 1 hour | --- | | | |

ENVIRONMENT CONDITIONS
IN DOOR USE ONLY

POLLUTION DEGREE : 2

CAT II

GENERAL SPECIFICATION

| | |
|--------------------------|--|
| Power Rating | 120 Vrms \pm 10% , 60Hz |
| Power Consumption | Max. 0.6 Watt |
| Ratings | 10Amp <1320 Watts> , Resistive and Inductive , 600 Watts Tungsten , 1/3 H.P. 120 V.A.C. |
| L/W/H | 21/2 x 21/2 x 23/8 |
| Weight | Around 4 Oz. |

Maintenance:

✓ Protect the Save A Watt Edge[®] from adverse weather conditions. The Save A Watt Edge[®] is not waterproof.

CAUTION: To avoid damage to the Save A Watt Edge[®], do not expose it to sprays, liquids, or solvents.

✓ Clean the exterior of the Save A Watt Edge[®] by removing dust with a lint-free cloth.

P3 INTERNATIONAL CORPORATION LIMITED WARRANTY

P3 INTERNATIONAL CORPORATION ("P3") warrants to the original retail purchaser only, that its product is free from defects in material or workmanship under the condition of normal use and service for a period of six (6) months from the date of purchase. In the event that a defect, malfunction or failure occurs or is discovered during the warranty period, P3 will repair or replace at its option the product or component part(s) which shall appear in the reasonable judgment of P3 to be defective or not to factory specifications. A product requiring service is to be returned to P3 along with the sales receipt or other proof of purchase acceptable to P3 and a statement describing the defect or malfunction. All transportation costs shall be borne by the owner and the risk of loss shall be upon the party initiating the transportation. All items repaired or replaced thereunder shall be subjected to the same limited warranty for a period of six (6) months from the day P3 ships the repaired or replaced product. The warranty does not apply to any product that has been subject to misuse, tampering, neglect, or accident or as a result of unauthorized alterations or repairs to the product. This warranty is void if the serial number (if any) has been removed, altered, or defaced. This warranty is in lieu of all warranties expressed or implied, including the implied warranties of merchantability and fitness for a particular purpose which are expressly excluded or disclaimed. P3 shall not be responsible for consequential, incidental or other damages, and P3 expressly excludes and disclaims liability for any damages resulting from the use, operation, improper application, malfunction or defeat of any P3 product covered by this limited warranty. P3's obligation is strictly and exclusively limited to the replacement or repair of any defective product or component part(s). Some states do not allow the exclusion or limitation of incidental or consequential damages, so the above limitation or exclusion may not apply to you. P3 does not assume or authorize anyone to assume for it any other obligation whatsoever. Some states do not allow limitation on how long an implied warranty lasts, so the above limitations may not apply to you. It is the owner/user's responsibility to comply with local, state, or federal regulations, if any, that may pertain to P3 products or their use. This warranty gives you specific legal rights, and you may also have other rights which vary from state to state. If you experience difficulty in the operation of your unit, or if your unit requires repair please contact:

P3 INTERNATIONAL CORPORATION

TECHNICAL SUPPORT

Tel: 212-741-7289

Fax: 212-741-2288

Email: techsupport@p3international.com

Rev1113